



Heavy-Duty

Resin Dock Ladder

Assembly Instructions



4-Step Configuration



5-Step Configuration

We're Here To Help!

Call Toll Free **1-888-752-9782**
Customer Service: Monday - Friday, 8:00 A.M. to 5:00 P.M. C.S.T.

PS 1605

TABLE OF CONTENTS

Dock Ladder Configuration	3
4-Step Configuration	3
5-Step Configuration	3
Premium Dock Attachment	5
Aluminum Dock Attachment	8
Commercial Grade or Standard Dock Attachment	12
Warranty Registration	15

COMPONENTS INCLUDED

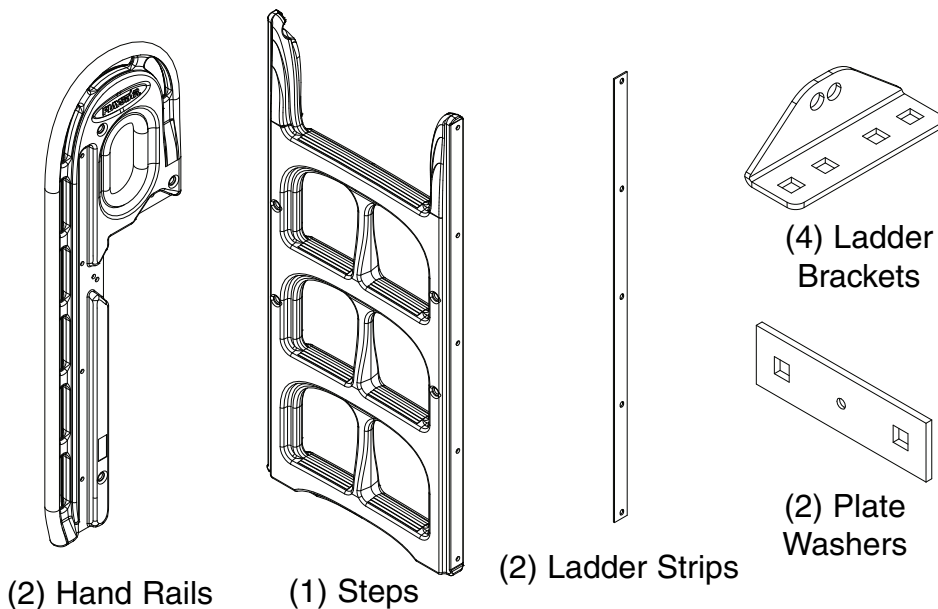

COMPONENTS REQUIRED FOR PREMIUM DOCK ONLY

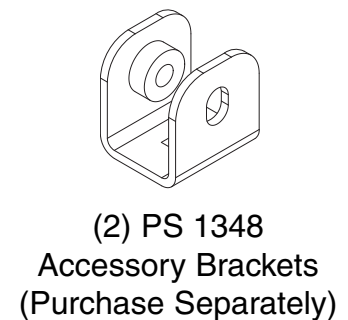

HARDWARE INCLUDED

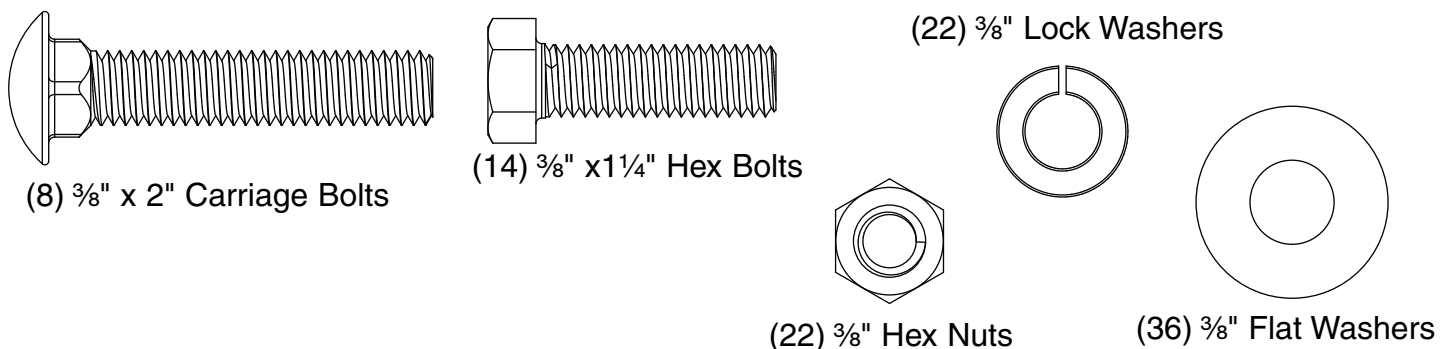

TOOLS REQUIRED

Pencil	Safety Glasses	Drill	Tape Measure
Hammer	$\frac{1}{16}$ " Wrench	$\frac{3}{8}$ " drill bit	Sawhorses (optional)
	Socket Wrench	$\frac{9}{16}$ " socket	

SELECT YOUR CONFIGURATION

Select your configuration based on the height from the bottom of the water to the top of your dock.

Items for STEP 1:

- (2) Hand Rails
- (1) Steps
- (2) Ladder Strips
- (10) $\frac{3}{8}$ " x $1\frac{1}{4}$ " Hex Bolts
- (20) $\frac{3}{8}$ " Flat Washers
- (10) $\frac{3}{8}$ " Lock Washers
- (10) $\frac{3}{8}$ " Hex Nuts

Position the hand rails, the ladder strips and the steps as shown.

Attach hand rails to steps using $\frac{3}{8}$ " x $1\frac{1}{4}$ " hex bolts, $\frac{3}{8}$ " flat washers, $\frac{3}{8}$ " lock washers and $\frac{3}{8}$ " hex nuts as shown.

Tighten firmly using a $\frac{9}{16}$ " socket and wrench but do not overtighten.

4-Step Assembly

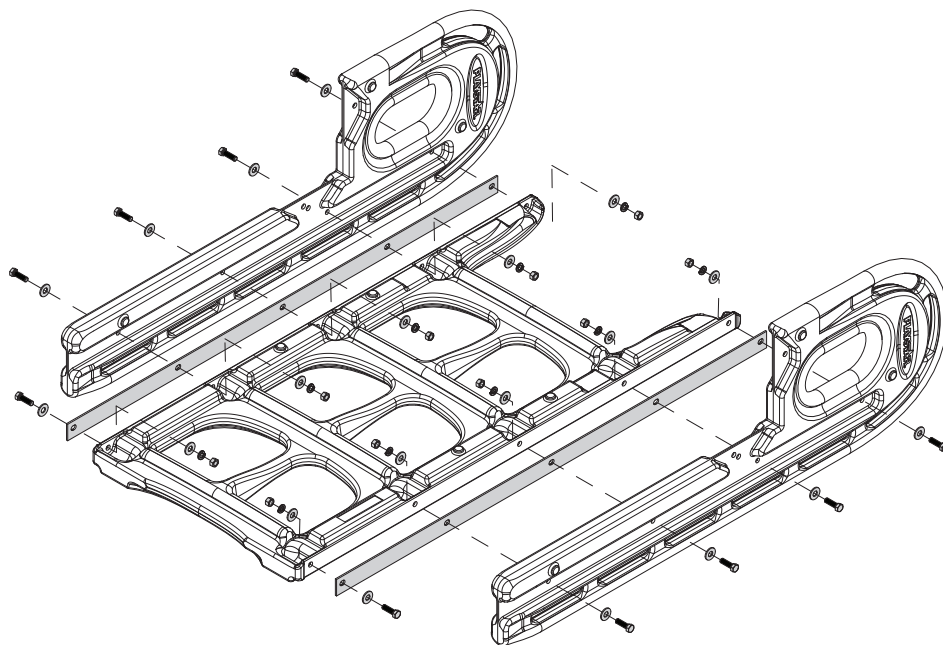
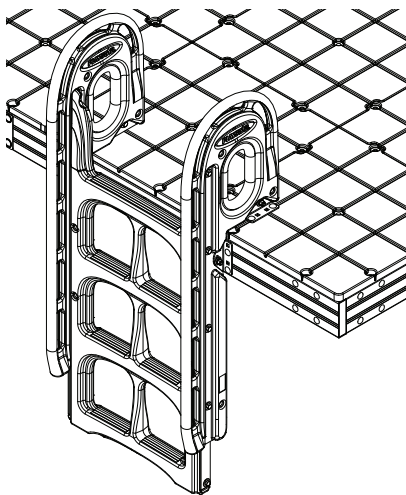

5-Step Assembly

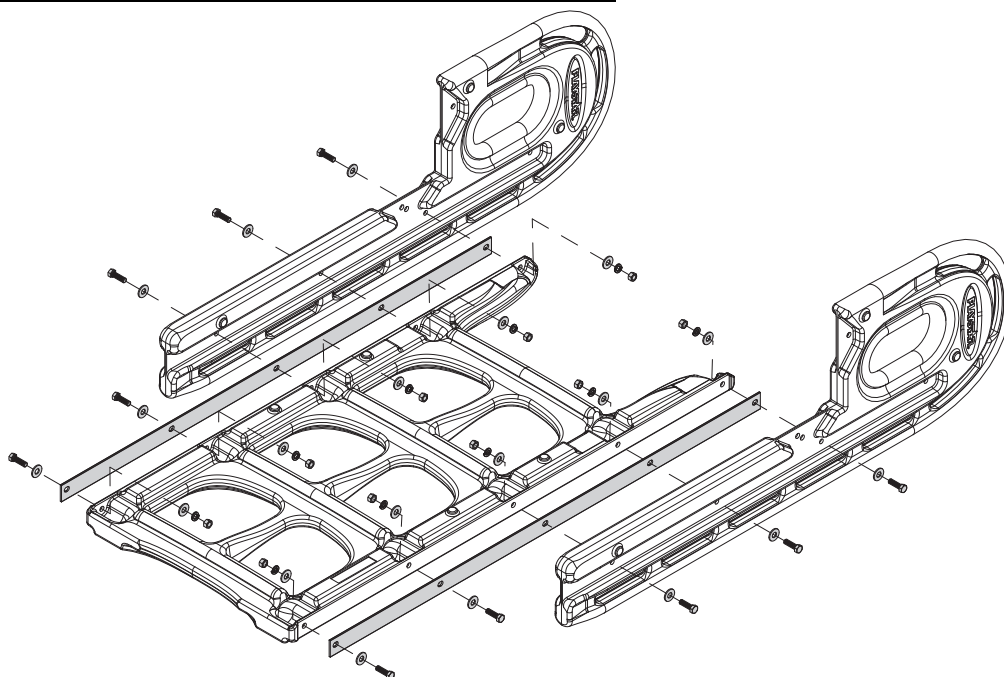
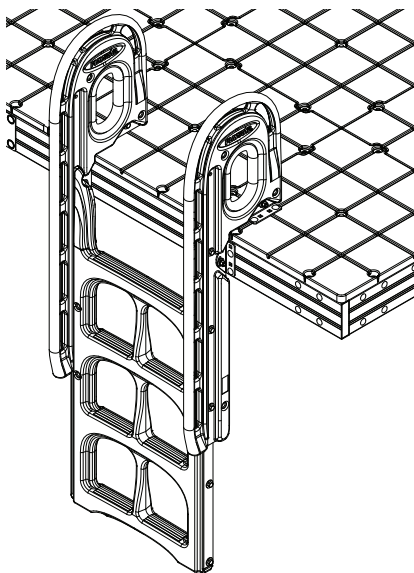

Items for **STEP 2:**

- (2) Ladder Brackets
- (2) $\frac{3}{8}$ " x $1\frac{1}{4}$ " Hex Bolts
- (4) $\frac{3}{8}$ " Flat Washers
- (2) $\frac{3}{8}$ " Lock Washers
- (2) $\frac{3}{8}$ " Hex Nuts

Attach bracket temporarily to outside of the hand rail using $\frac{3}{8}$ " x $1\frac{1}{4}$ " hex bolts, $\frac{3}{8}$ " flat washers, $\frac{3}{8}$ " lock washers and $\frac{3}{8}$ " hex nuts as shown.

Repeat for the other side.

Hand tighten nuts at this time.

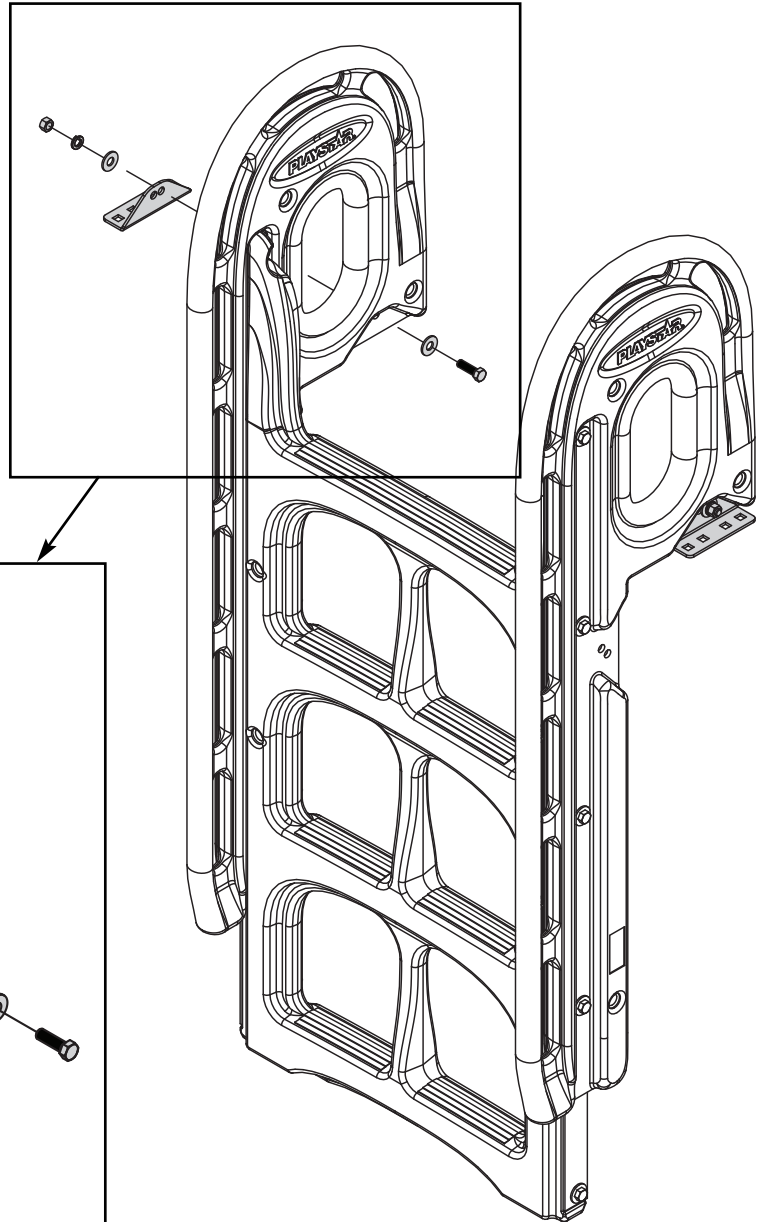

***If installing on a Premium Dock, go to Page 5.
If installing on an Aluminum Dock, go to Page 8.
If installing on a Commercial Grade or Standard Dock, go to Page 12.***

INSTALLATION ON A PREMIUM DOCK

Additional Items Required for STEP 3: (2) PS 1348 Accessory Brackets (Purchase Separately)

INSTALL ACCESSORY BRACKETS

IMPORTANT: Accessory Brackets (PS 1348) come with $\frac{3}{8}$ " x 1" GALVANIZED carriage bolts for mounting the brackets to the dock frame and $\frac{3}{8}$ " x 1" STAINLESS STEEL hex bolts for mounting the ladder brackets to the accessory brackets.

DO NOT use the galvanized hex bolts supplied with the dock frame kit to attach the ladder brackets or other accessories. Although they look similar to stainless steel, the galvanized hex bolt will damage the accessory brackets.

STEP 3: Adding Accessory Brackets

At the desired location, install the Accessory Brackets 24" apart as shown.

Remove 1" bolts where needed for Accessory Brackets.

Position Accessory Brackets top and bottom as shown. Secure with $\frac{3}{8}$ " x 1" carriage bolt, $\frac{3}{8}$ " washers and $\frac{3}{8}$ " lock nuts.

Note: Brackets should be straight and flush with the side of the trim.

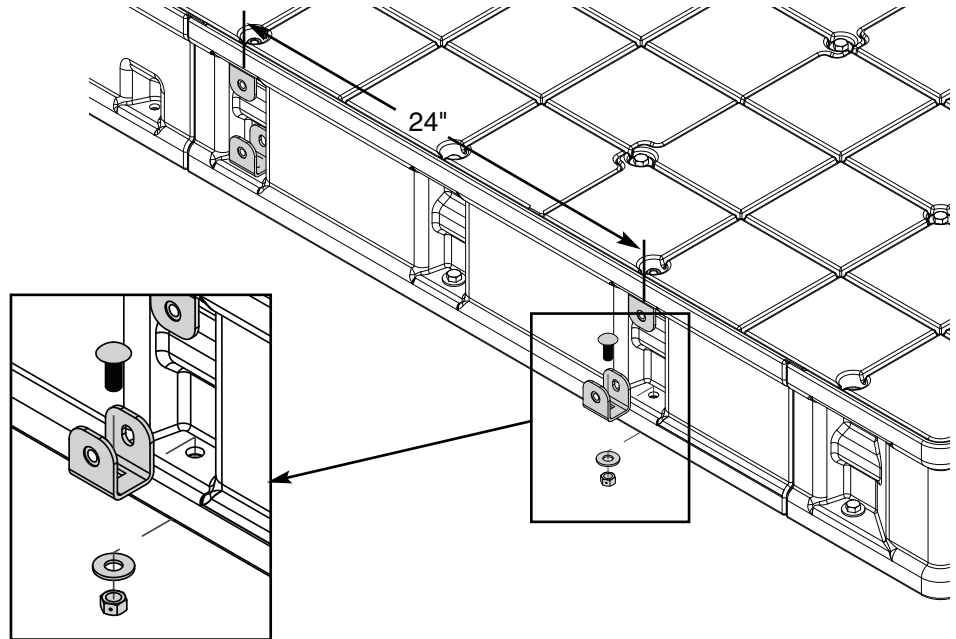

Items for STEP 4:

- (2) Ladder Brackets
- (4) $\frac{3}{8}$ " x 1" Stainless Steel Hex Bolts (supplied with the Accessory Bracket)
- (4) $\frac{3}{8}$ " Flat Washers

Attach the ladder brackets to the frame as shown.

Position the ladder brackets facing each other as shown. Secure with $\frac{3}{8}$ " x 1" STAINLESS STEEL hex bolts provided with Accessory Brackets and $\frac{3}{8}$ " flat washers provided with the Dock Ladder.

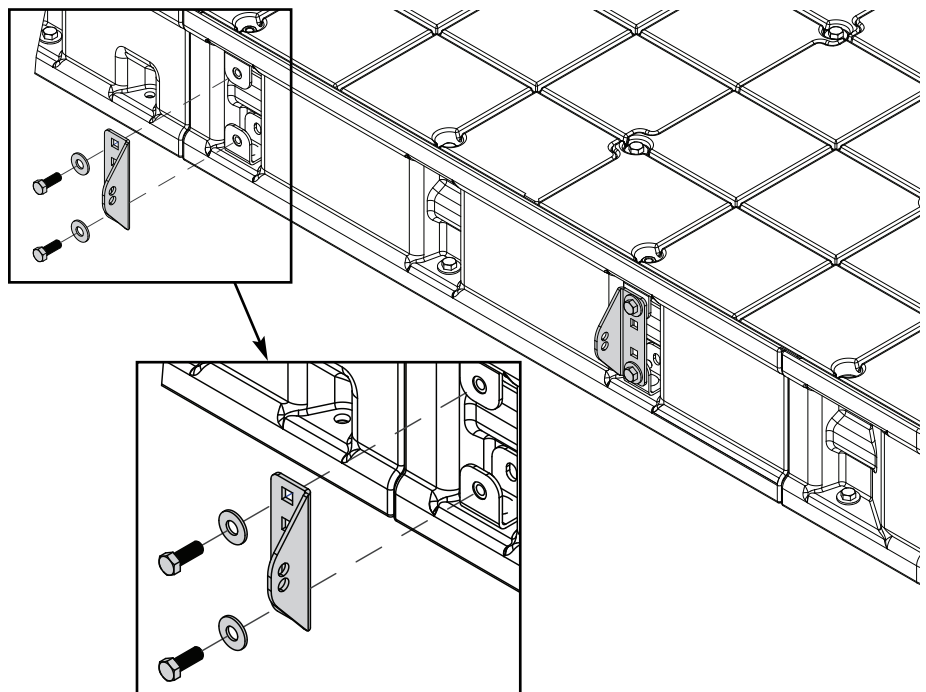

Items for **STEP 5:**

- (1) Ladder Assembly
- (2) $\frac{3}{8}$ " x $1\frac{1}{4}$ " Hex Bolts
- (2) $\frac{3}{8}$ " Flat Washers

Attach the ladder temporarily to the dock as shown.

Make sure the ladder is resting firmly against the top and side of the dock. Temporarily insert a $\frac{3}{8}$ " x $1\frac{1}{4}$ " hex bolt and a $\frac{3}{8}$ " flat washer through the side bracket to hold ladder in place as shown.

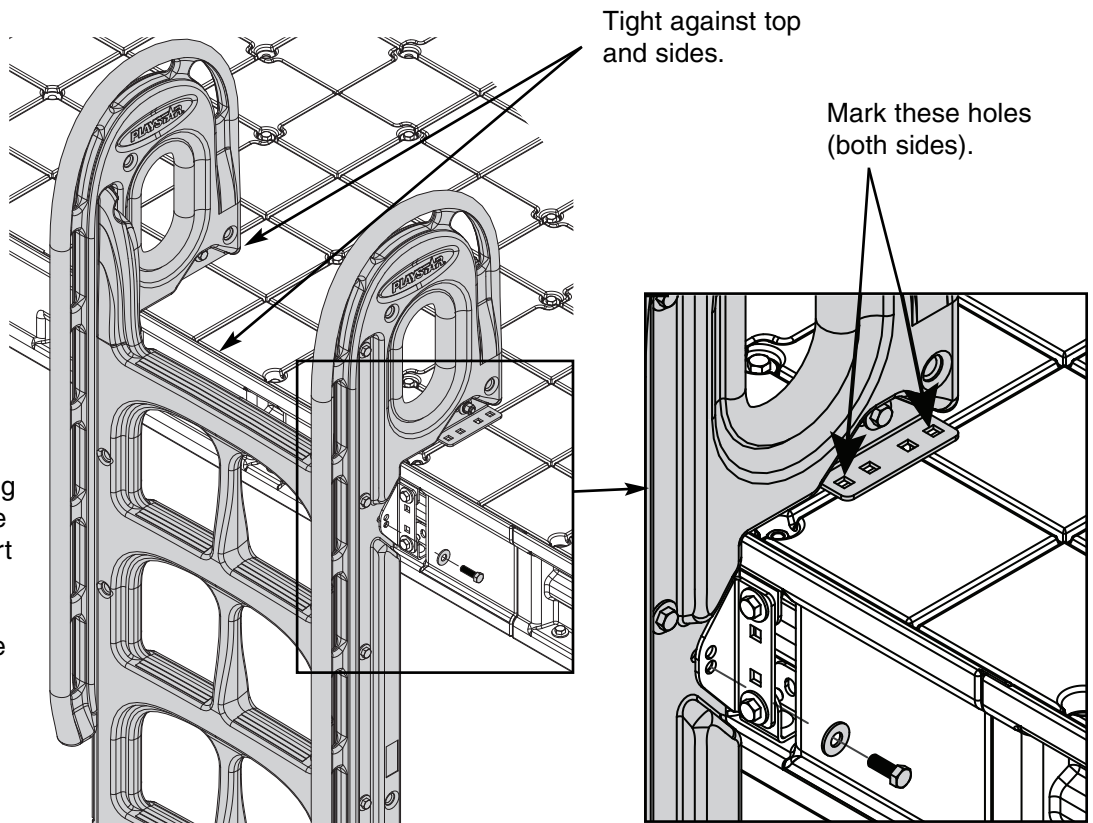

Mark the two outermost holes of the two top brackets inside the groove of the Resin Dock Top as shown.

Remove the ladder from the dock and remove the two brackets installed temporarily on the ladder.

Items for **STEP 6:**

- (2) Ladder Brackets
- (2) Plate Washers
- (4) $\frac{3}{8}$ " x 2" Carriage Bolts
- (4) $\frac{3}{8}$ " Flat Washers
- (4) $\frac{3}{8}$ " Lock Washers
- (4) $\frac{3}{8}$ " Hex Nuts

At the previously marked locations, drill $\frac{3}{8}$ " holes through the top of the dock.

Position ladder brackets on the top facing each other and place plate washers at the bottom as shown.

Secure using $\frac{3}{8}$ " x 2" carriage bolts, $\frac{3}{8}$ " flat washers, $\frac{3}{8}$ " lock washers and $\frac{3}{8}$ " hex nuts as shown. Do not over tighten.

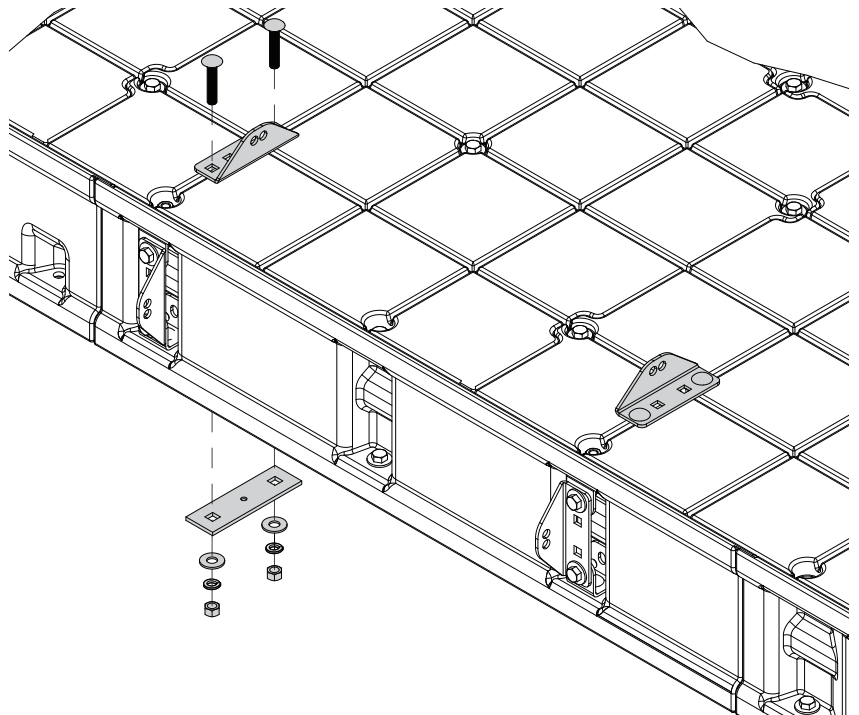

NOTE: If you are installing the ladder on a floating dock, you will need to remove the float(s) located under the brackets prior to this step. After completing this step, reattach the float(s).

Items for **STEP 7:**

- (1) Ladder Assembly
- (4) $\frac{3}{8}$ " x $1\frac{1}{4}$ " Hex Bolts
- (8) $\frac{3}{8}$ " Flat Washers
- (4) $\frac{3}{8}$ " Lock Washers
- (4) $\frac{3}{8}$ " Hex Nuts

Attach ladder to dock permanently making sure it rests firmly against the top and sides of the dock.

Secure using $\frac{3}{8}$ " x $1\frac{1}{4}$ " hex bolts, $\frac{3}{8}$ " flat washers, $\frac{3}{8}$ " lock washers and $\frac{3}{8}$ " hex nuts as shown. Do not over tighten.

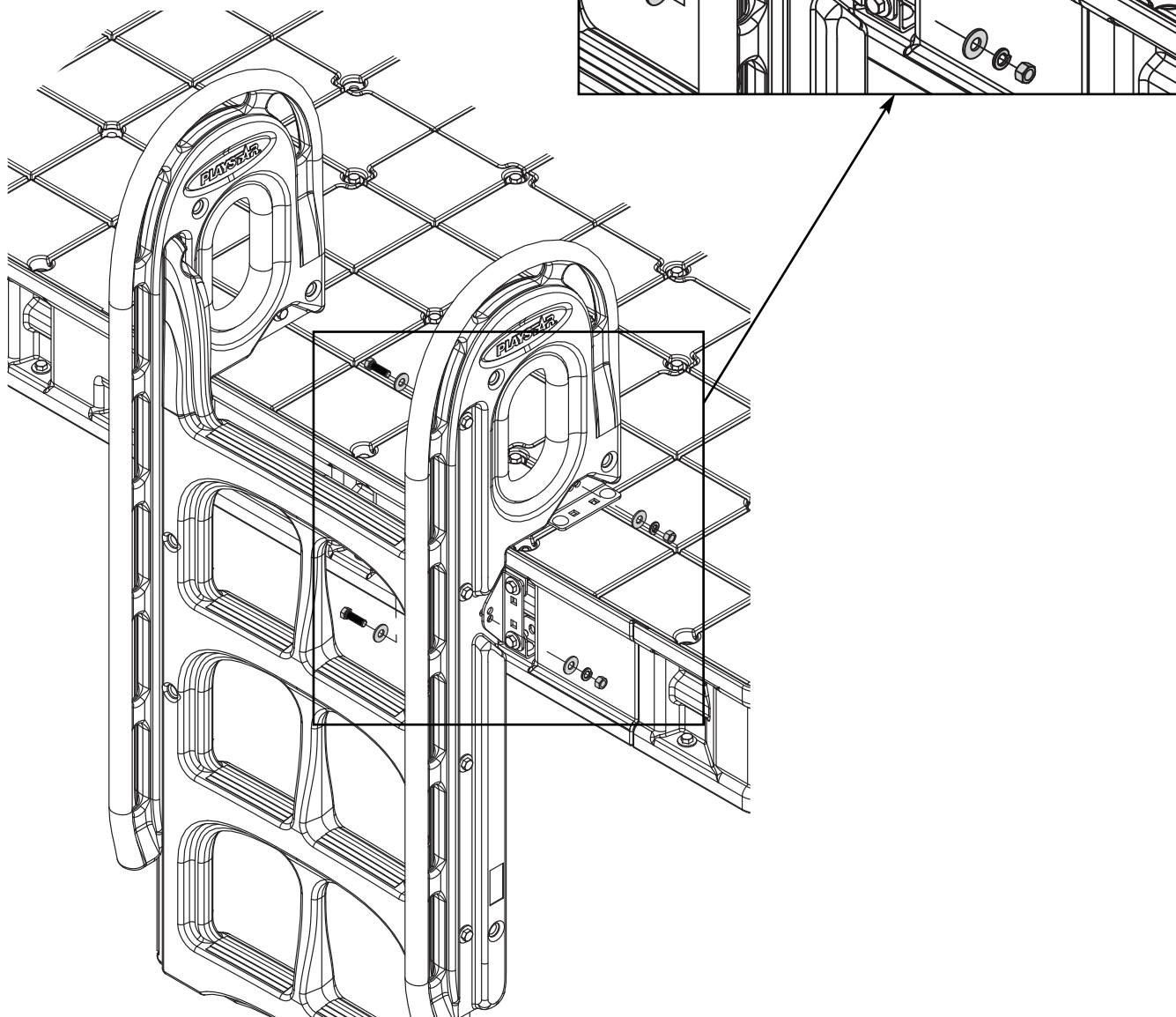

NOTE: Before using the ladder, ALWAYS make sure it is firmly secured to the dock.

INSTALLATION ON AN ALUMINUM DOCK

Items for **STEP 3:**

- (2) Ladder Brackets
- (2) $\frac{3}{8}$ " x $1\frac{1}{4}$ " Hex Bolts
- (4) $\frac{3}{8}$ " Flat Washers
- (2) $\frac{3}{8}$ " Lock Washers
- (2) $\frac{3}{8}$ " Hex Nuts

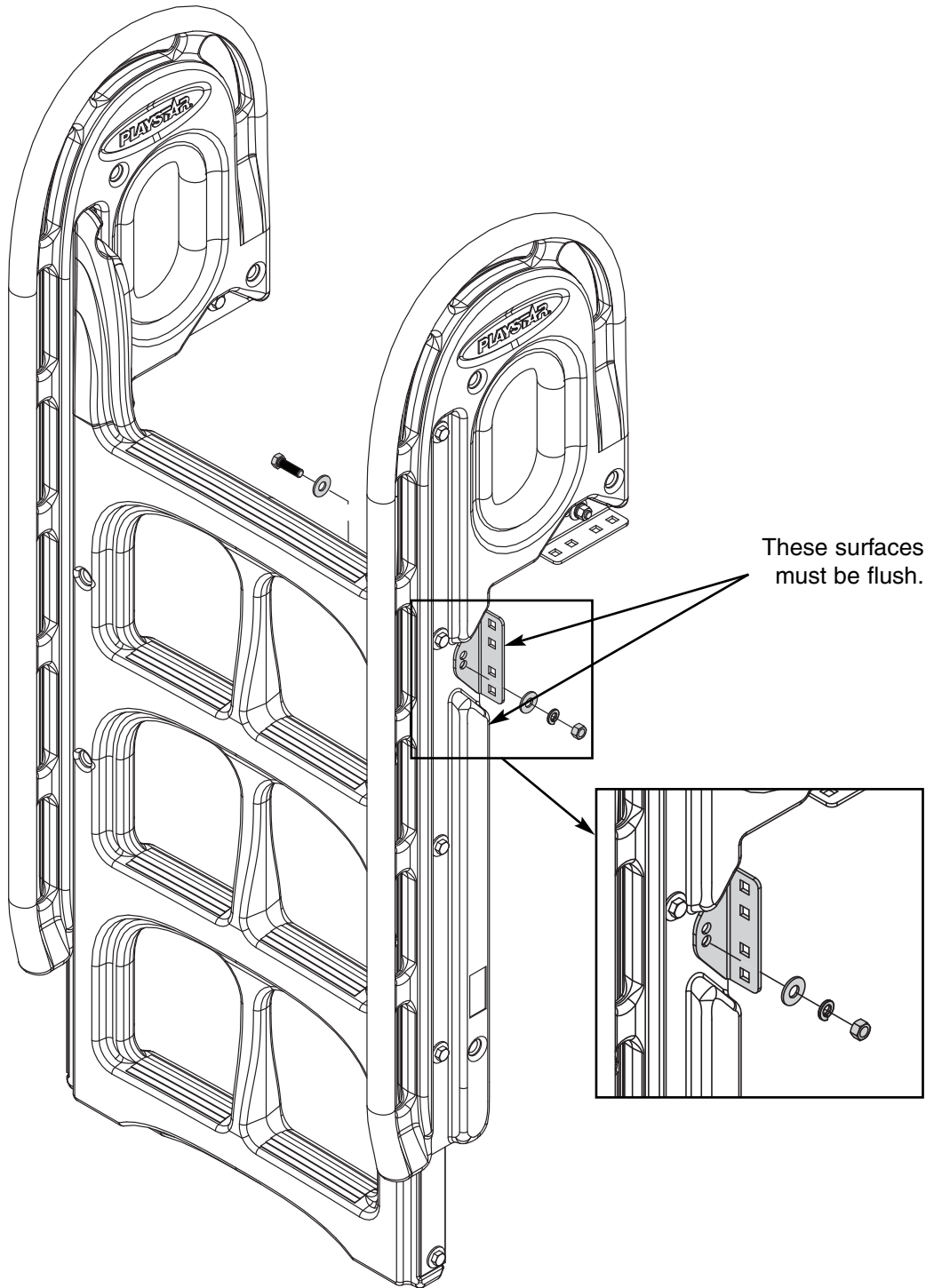

Place the bracket on the outside of the hand rail, the back surface of the bracket must be flush with the back of the hand rail. The bracket must also be as close as possible to the TOP of the pocket as shown.

Using the lower hole of the bracket, attach bracket temporarily to the hand rail using $\frac{3}{8}$ " x $1\frac{1}{4}$ " hex bolts, $\frac{3}{8}$ " flat washers, $\frac{3}{8}$ " lock washers and $\frac{3}{8}$ " hex nuts as shown.

Repeat for the other side. Hand tighten nuts at this time.

Items for STEP 4: (1) Ladder Assembly

RESIN DOCK TOP Fig. 1

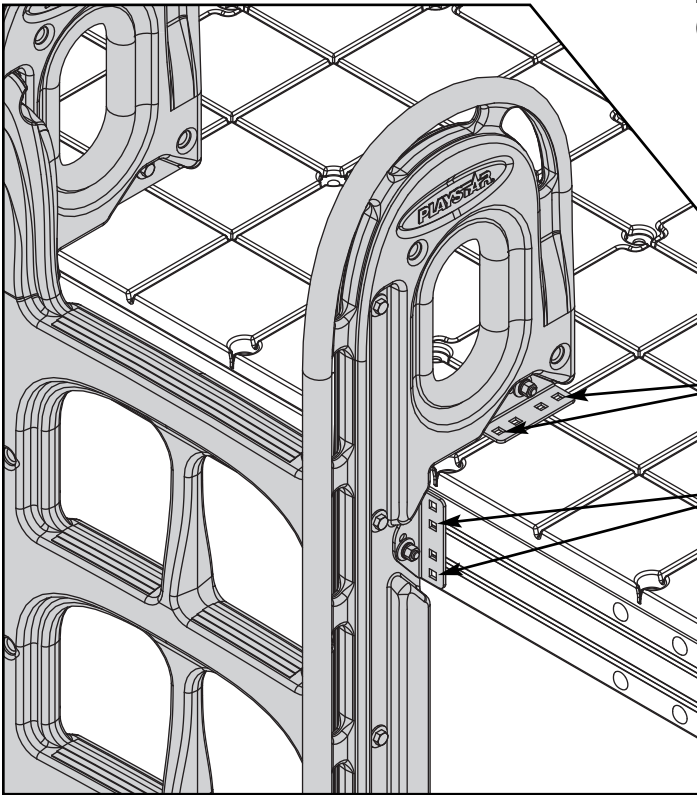

Set the ladder temporarily at the desired location. Make sure ladder is resting firmly against the top and side of the dock. (Fig. 1 or Fig. 2)

When attaching the ladder to a dock with a Resin Dock Top (PS 1320), align the holes of the top bracket over the grooves of the Resin Dock Top and mark the two outermost holes of the bracket as shown.

The side bracket needs to be marked at the first and third hole up from the bottom as shown.

Repeat for the other side.

Remove the ladder from the dock and remove all four brackets temporarily installed on the ladder.

Warning: Do not install brackets over the joints of two 2' x 2' dock top sections. Brackets must be installed on a continuous section of the Resin Dock Top.

WOOD OR COMPOSITE DECKING Fig. 2

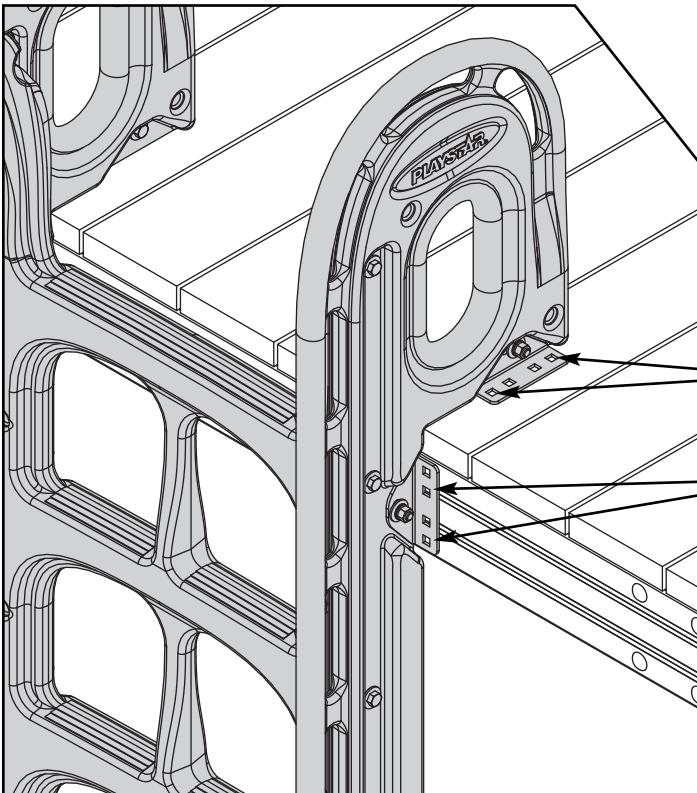

When attaching the ladder to a dock with wood or composite decking, align the holes of the top bracket with the center of the planks and mark the two outermost holes of the bracket as shown.

The side bracket needs to be marked at the first and third hole up from the bottom as shown.

Repeat for the other side.

Remove the ladder from the dock and remove all four brackets temporarily installed on the ladder.

Note: Failure to use the holes identified will create an interference when bolting brackets to the dock.

Items for **STEP 5:**

- (4) Ladder Brackets
- (2) Plate Washers
- (8) $\frac{3}{8}$ " x 2" Carriage Bolts
- (8) $\frac{3}{8}$ " Flat Washers
- (8) $\frac{3}{8}$ " Lock Washers
- (8) $\frac{3}{8}$ " Hex Nuts

At the previously marked locations, drill $\frac{3}{8}$ " holes through the top and side of the dock.

Fig. 1

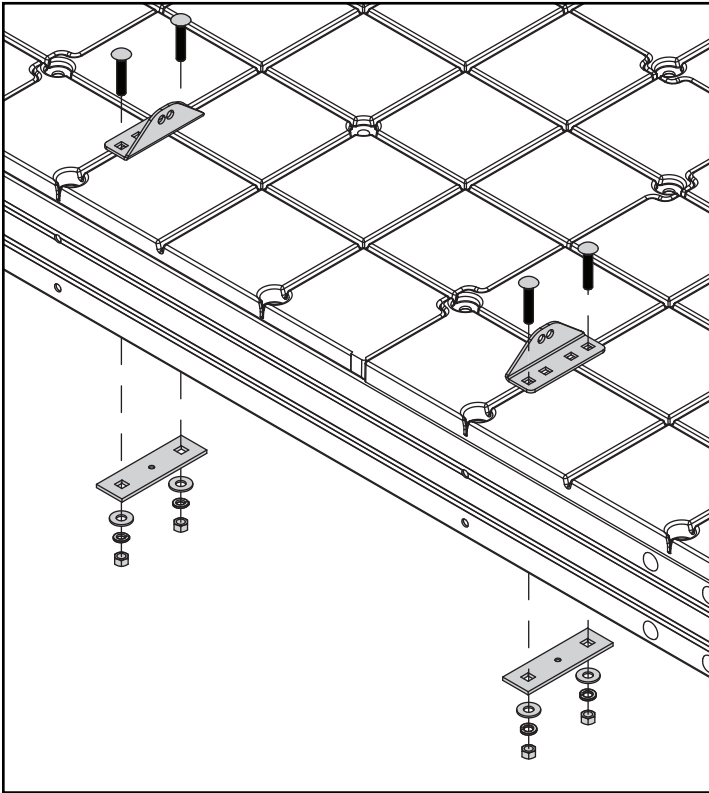

Attach ladder brackets on the top facing each other and place plate washers at the bottom as shown (Fig. 1). Secure using $\frac{3}{8}$ " x 2" carriage bolts, $\frac{3}{8}$ " flat washers, $\frac{3}{8}$ " lock washers and $\frac{3}{8}$ " hex nuts as shown. Do not over tighten.

Note: If decking boards are 2" or thicker, you will need to remove plate washer.

Fig. 2

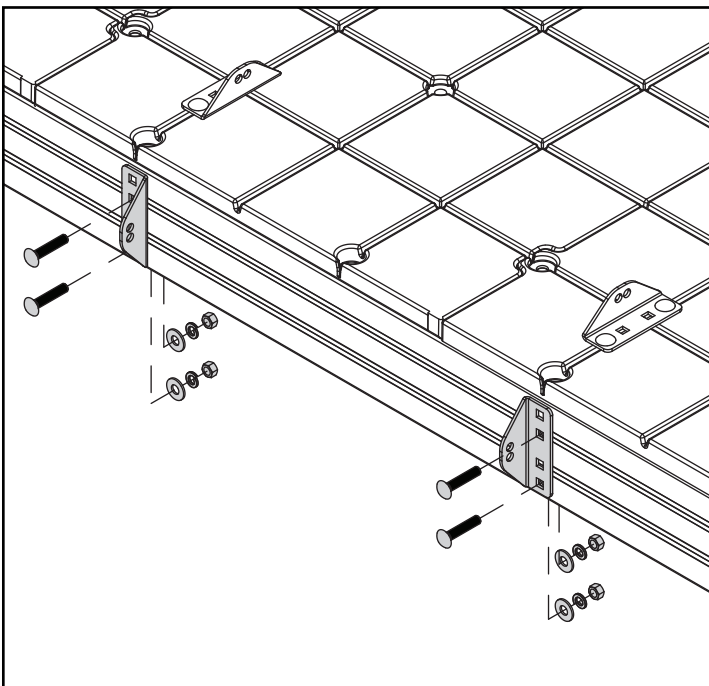

Attach ladder brackets to the side of the dock facing each other as shown (Fig. 2). Secure using $\frac{3}{8}$ " x 2" carriage bolts, $\frac{3}{8}$ " flat washers, $\frac{3}{8}$ " lock washers and $\frac{3}{8}$ " hex nuts as shown.

NOTE: If you are installing the ladder on a floating dock, you will need to remove the float(s) located under the brackets prior to this step. After completing this step, reattach the float(s).

Items for **STEP 6:**

- (1) Ladder Assembly
- (4) $\frac{3}{8}$ " x $1\frac{1}{4}$ " Hex Bolts
- (8) $\frac{3}{8}$ " Flat Washers
- (4) $\frac{3}{8}$ " Lock Washers
- (4) $\frac{3}{8}$ " Hex Nuts

Attach ladder to dock permanently making sure it rests firmly against the top and sides of the dock.

Secure using $\frac{3}{8}$ " x $1\frac{1}{4}$ " hex bolts, $\frac{3}{8}$ " flat washers, $\frac{3}{8}$ " lock washers and $\frac{3}{8}$ " hex nuts as shown. Do not over tighten.

Repeat for the other side.

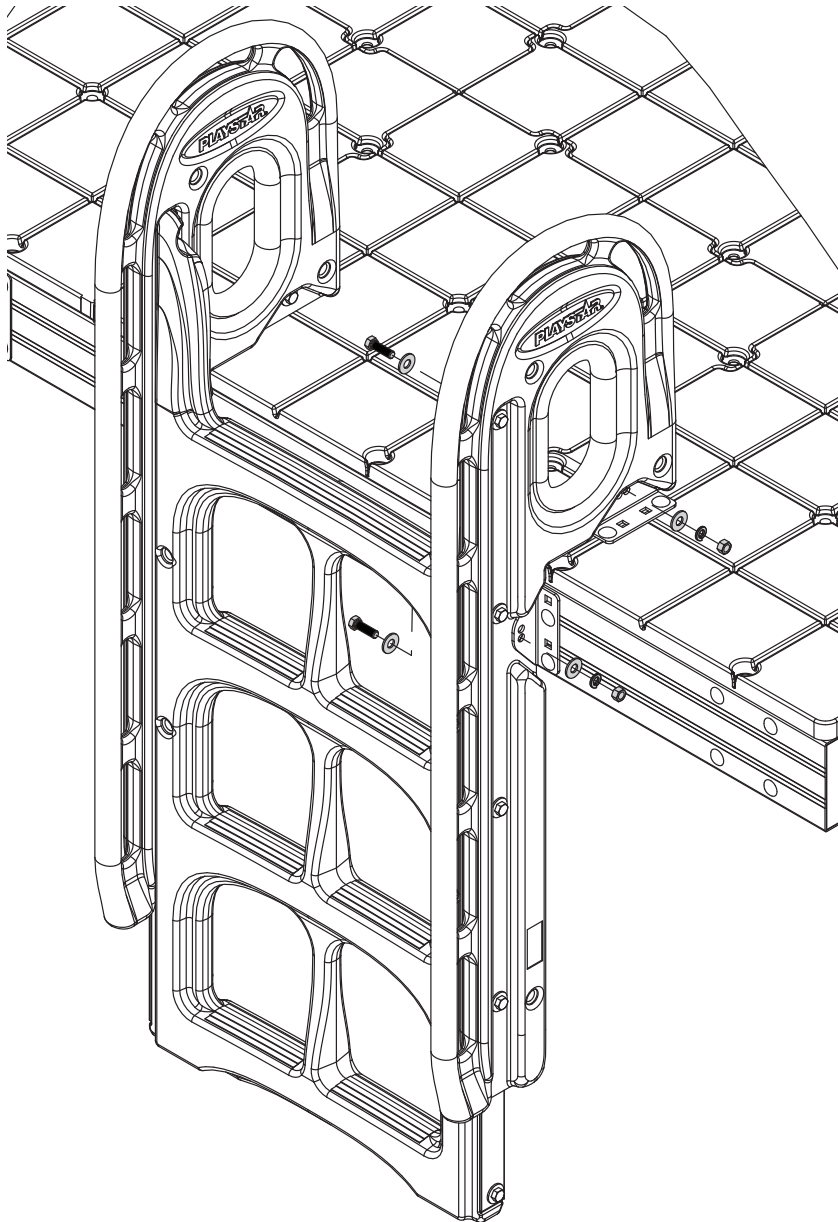

NOTE: Before using the ladder, ALWAYS make sure it is firmly secured to the dock.

INSTALLATION ON A COMMERCIAL GRADE OR STANDARD DOCK

Items for **STEP 3:**

- (2) Ladder Brackets
- (2) $\frac{3}{8}$ " x $1\frac{1}{4}$ " Hex Bolts
- (4) $\frac{3}{8}$ " Flat Washers
- (2) $\frac{3}{8}$ " Lock Washers
- (2) $\frac{3}{8}$ " Hex Nuts

Place the bracket on the outside of the hand rail, the back surface of the bracket must be flush with the back of the hand rail. The bracket must also be as close as possible to the **BOTTOM** of the pocket as shown.

Using the upper hole, attach bracket temporarily to the hand rail using $\frac{3}{8}$ " x $1\frac{1}{4}$ " hex bolts, $\frac{3}{8}$ " flat washers, $\frac{3}{8}$ " lock washers and $\frac{3}{8}$ " hex nuts as shown.

Repeat for the other side. Hand tighten nuts at this time.

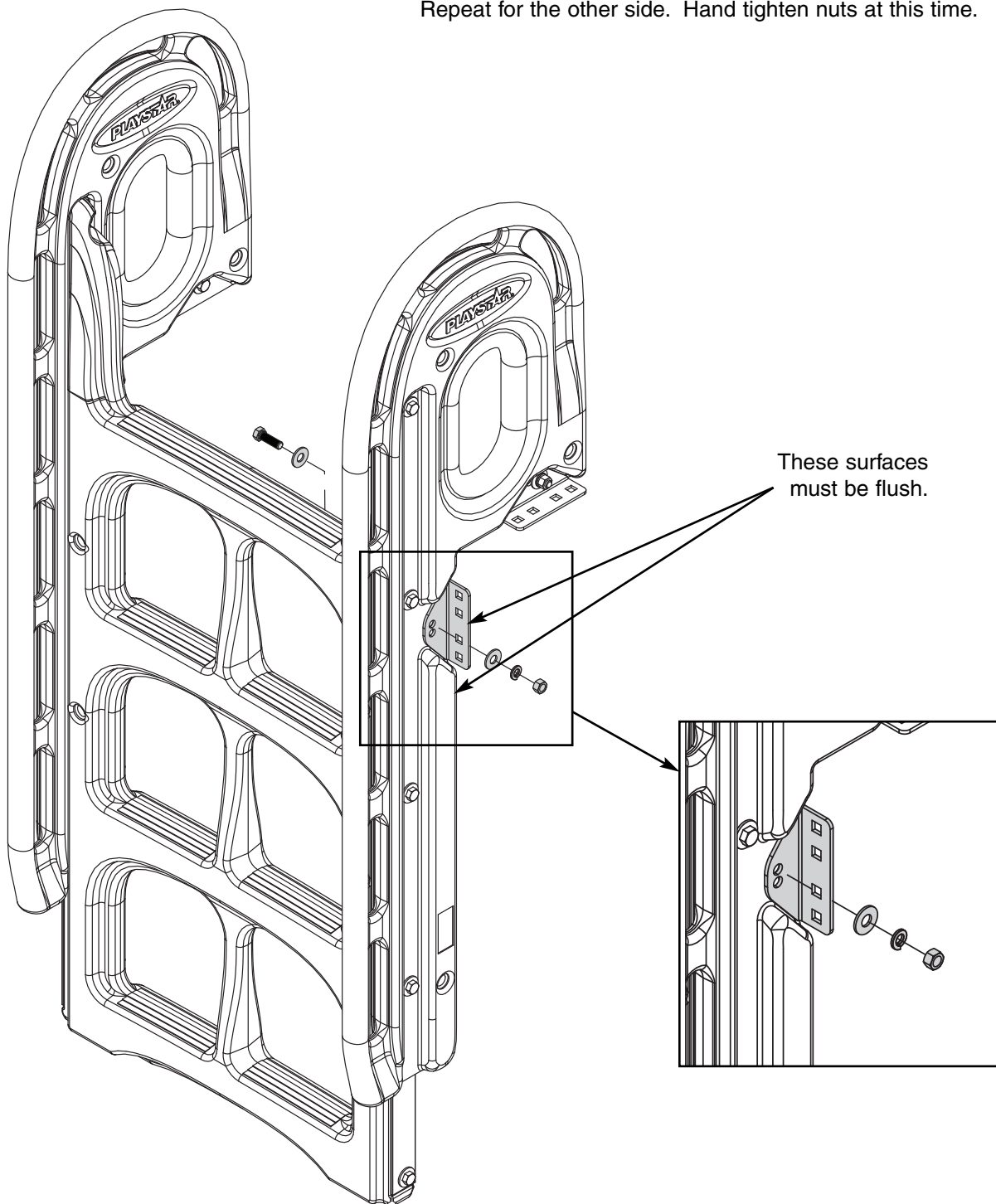

Items for **STEP 4:** (1) Ladder Assembly

WOOD OR COMPOSITE DECKING

Fig. 1

Set the ladder temporarily at the desired location as shown. Make sure ladder is resting firmly against the top and side of the dock. (Fig. 1 or Fig. 2)

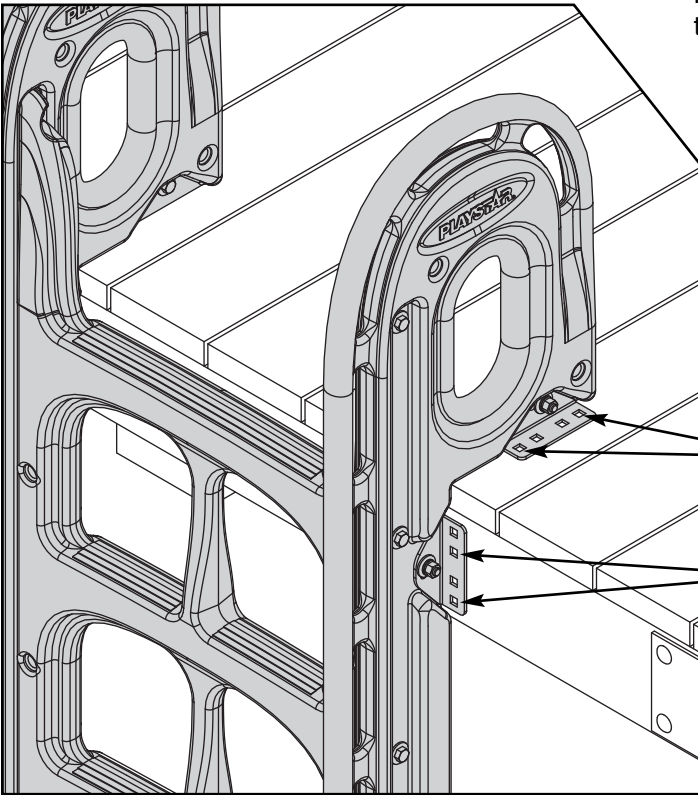

When attaching the ladder to a dock with wood or composite decking, align the holes of the top bracket with the center of the planks and mark the two outermost holes of the bracket as shown.

The side bracket needs to be marked at the first and third hole up from the bottom as shown.

Repeat for the other side.

Remove the ladder from the dock and remove all four brackets temporarily installed on the ladder.

RESIN DOCK TOP

Fig. 2

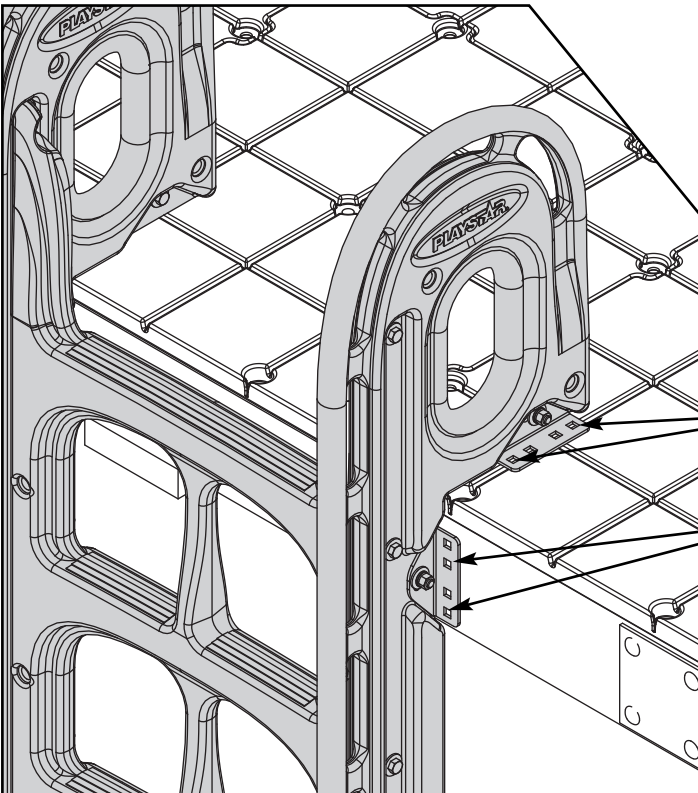

When attaching the ladder to a dock with a Resin Dock Top (PS 1320), align the holes of the top bracket over the grooves of the Resin Dock Top and mark the two outermost holes of the bracket as shown.

The side bracket needs to be marked at the first and third hole up from the bottom as shown.

Repeat for the other side.

Remove the ladder from the dock and remove all four brackets temporarily installed on the ladder.

Warning: Do not install brackets over the joints of two 2' x 2' dock top sections. Brackets must be installed on a continuous section of the Resin Dock Top.

Note: Failure to use the holes identified will create an interference when bolting brackets to the dock.

Items for **STEP 5:**

- (4) Ladder Brackets
- (2) Plate Washers
- (8) $\frac{3}{8}$ " x 2" Carriage Bolts
- (8) $\frac{3}{8}$ " Flat Washers
- (8) $\frac{3}{8}$ " Lock Washers
- (8) $\frac{3}{8}$ " Hex Nuts

At the previously marked locations, drill $\frac{3}{8}$ " holes through the top and side of the dock.

Fig. 1

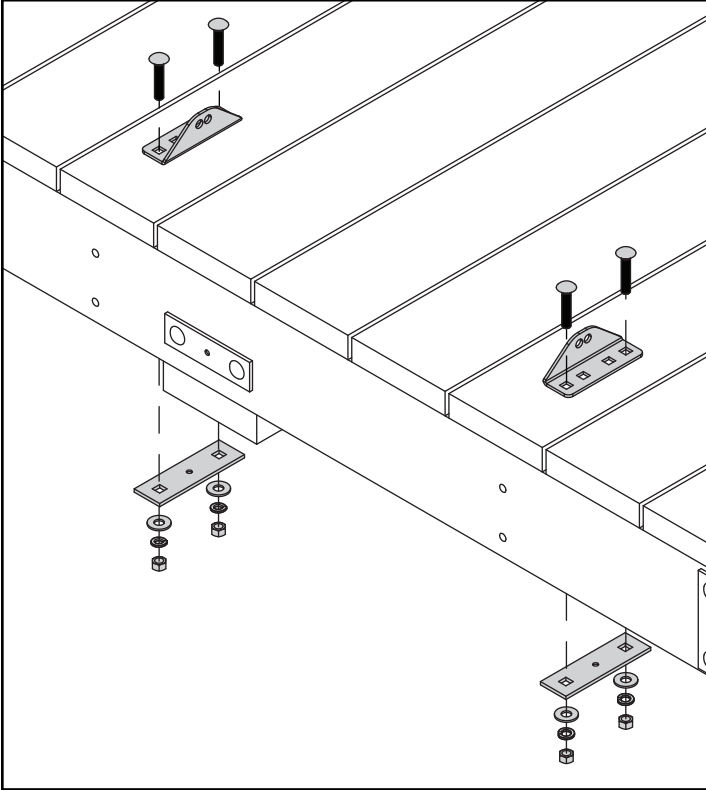

Attach ladder brackets on the top facing each other and place plate washers at the bottom as shown (Fig. 1). Secure using $\frac{3}{8}$ " x 2" carriage bolts, $\frac{3}{8}$ " flat washers, $\frac{3}{8}$ " lock washers and $\frac{3}{8}$ " hex nuts as shown. Do not over tighten.

Note: If decking boards are 2" or thicker, you will need to remove plate washer.

Fig. 2

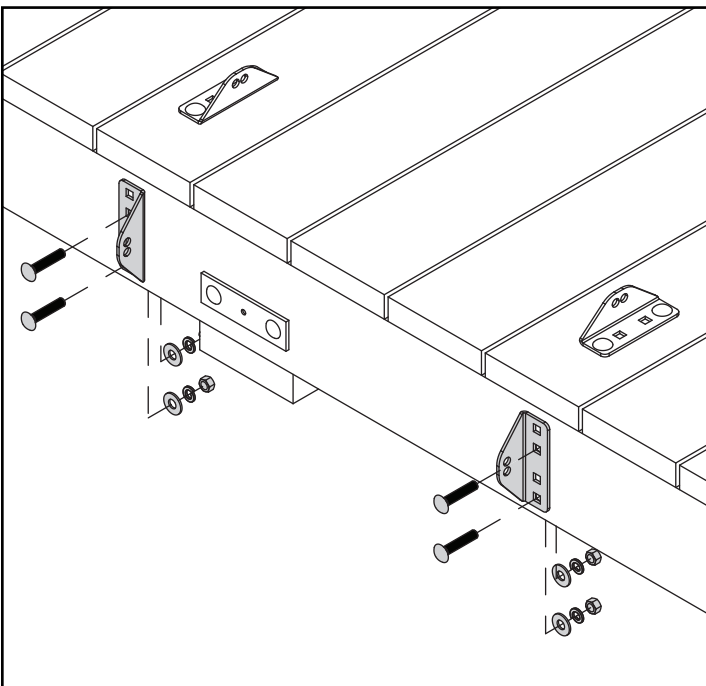

Attach ladder brackets to the side of the dock facing each other as shown (Fig. 2). Secure using $\frac{3}{8}$ " x 2" carriage bolts, $\frac{3}{8}$ " flat washers, $\frac{3}{8}$ " lock washers and $\frac{3}{8}$ " hex nuts as shown.

NOTE: If you are installing the ladder on a floating dock, you will need to remove the float(s) located under the brackets prior to this step. After completing this step, reattach the float(s).

Items for **STEP 6:**

- (1) Ladder Assembly
- (4) $\frac{3}{8}$ " x $1\frac{1}{4}$ " Hex Bolts
- (8) $\frac{3}{8}$ " Flat Washers
- (4) $\frac{3}{8}$ " Lock Washers
- (4) $\frac{3}{8}$ " Hex Nuts

Attach ladder to dock permanently making sure it rests firmly against the top and sides of the dock.

Secure using $\frac{3}{8}$ " x $1\frac{1}{4}$ " hex bolts, $\frac{3}{8}$ " flat washers, $\frac{3}{8}$ " lock washers and $\frac{3}{8}$ " hex nuts as shown. Do not over tighten.

Repeat for the other side.

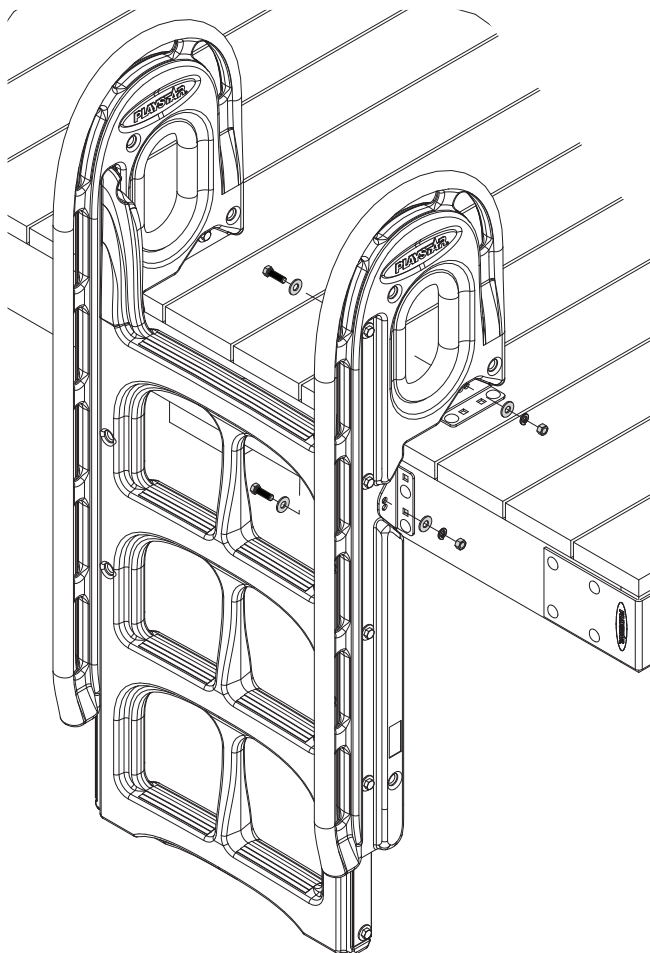

NOTE: Before using the ladder, ALWAYS make sure it is firmly secured to the dock.

STATEMENT OF WARRANTY 15-Year Warranty

PlayStar, Inc. warrants these goods to be free from defects in material and workmanship under normal and proper usage and is limited to the original owner.

No warranty is offered on goods subject to normal wear and tear, unreasonable use, abuse, improper installation or maintenance, vandalism, alterations or modifications, acts of God, cosmetic issues including scratches, rust and discoloration, or product not used as intended or designed.

PlayStar, Inc. reserves the right to examine photographs, physical merchandise claimed to be defective, and to recover said merchandise, freight prepaid by purchaser, prior to disposition of warranty claims.

PlayStar's sole liability under this warranty is strictly limited to the repair or replacement of any defective product. In no event shall PlayStar's liability under this warranty exceed the actual cost of materials necessary for repair or replacement of the product covered, whichever is less. PlayStar shall not be liable for incidental, indirect, or consequential damages caused by its products.

This warranty is in lieu of all other warranties, whether express or implied, including any warranties of merchantability or fitness for a particular purpose. This warranty gives you specific legal rights. You may have other rights that vary from state to state.

Registering your warranty:

Please complete your registration on-line at www.playstarinc.com/dockwarranty or use the card below and mail to the address indicated.

Warranty Registration Dock Ladder PS 1605

Name _____

Address _____

City _____

State _____ Zip _____

Phone _____

Date _____

Mail to:
PlayStar, Incorporated, PO Box 1777, Janesville, WI 53547





Thank You for choosing PlayStar. Because it is our intention to make this a positive family experience, we have taken great care in preparing this product. Should you have any questions or if we can assist you in any way, please call our friendly Customer Service Department for immediate action.

Do not return to the store.

Please call us Toll Free at 1-888-PLAYSTAR
(752-9782)

Monday through Friday, 8:00 A.M. to 5:00 P.M. C.S.T.

Ask for Customer Service.

We Will Gladly Help!



PlayStar, Incorporated, Janesville, WI 53547

© 2011, PlayStar, Inc. Reproduction of this document in part or whole is prohibited without the permission of PlayStar, Inc.

Patents Pending or Protected by one or more of the following United States or Foreign Patents: US 6,098,564; US 6,145,463; US 7,153,064; CA 2,270,012; CA 2,261,438